

ACOUSTIC POD

USER INSTRUCTION

P4F-2



PART LIST

Numbering Rule

- A-00
- B-00
- C-00
- D-00
- E-00
- F-00
- G-00
- H-00
- Y-00
- Aluminim
- Carbon Plastic Panel
- Glass
- Metal Hardware
- Upholstery
- Electronics
- Seal Strip
- Accessory
- Tool

Y-00 Tools

Code	Description	Qty.	Preview
Y-01	Torx Wrench	1	
Y-02	Rubber Mallet	1	
Y-03	Plastic Crowbar	1	
Y-04	Allen Wrench	2	
Y-05	Cross Head Screwdriver	1	
Y-06	Vacuum Handle	4	

Parts for tabletops

Code	Description	Qty.	Preview
A	M4 hex key wrench	1	
B	Bolt	6	
C	Bolt	6	
D	Bolt	11	
E	Bolt	3	

A-00 Aluminim

Code	Description	Qty.	Preview
A-01	Arc Beam-Upper(L)	1	
A-02	Arc Beam-Upper(R)	1	
A-03	Arc Beam-lower(L)	1	
A-04	Arc Beam-lower(R)	1	
A-05	Front Frame-Upper	1	
A-06	Rear Frame-Upper	1	
A-07	Front Frame-Lower	1	
A-08	Rear Frame-Lower	1	
A-09	Front Frame (L)	1	
A-10	Rear Frame (L)	1	
A-11	Front Frame (R)	1	
A-12	Rear Frame (R)	1	
A-15-22	Corner Cover	8	
A-23	Ambient Ligh Channel	2	
A-27	Square Tube	2	

B-00 Carbon Plastic Panel

Code	Description	Qty.	Preview
B11~15	Side Panel (L)	5	
B21~25	Side Panel (R)	5	
B31~35	Top Panel	5	
B41~45	Bottom Panel	5	
B51~61	Reinforced Floor Panel	11/10	

C-00 Glass

Code	Description	Qty.	Preview
C-02	Door	1	
C-01	Glass Wall -Front(L)	1	
C-03	Glass Wall -Front(R)	1	
C-04	Glass Wall -Rear(L)	1	
C-05	Glass Wall -Rear(M)	1	
C-06	Glass Wall -Rear(R)	1	

D-00 Metal Hardware

Code	Description	Qty.	Preview
D-03	Door Handle	1	
D-04	Door Closer	1	
D-05	Door Hinge	2	

E-00 Upholstery

Code	Description	Qty.	Preview
E11-14	Acoustic Panel(L)	4	
E21-24	Acoustic Panel(R)	4	
E31	Acoustic Ceiling Panel(L)	1	
E32	Acoustic Ceiling Panel(R)	1	
E-51	Carpet	1	

F-00 Electronics

Code	Description	Qty.	Preview
F-06	Light Switch	1	
F-07	Fan Switch	1	
F-09	IR Motion Sensor	1	
F-10	Center Light	1	

G-00 Seal Strip

Code	Description	Qty.	Preview
G-01	Silicone Seal Strip	1	
G-21~22	Acrylic adhesive strip Back glass	2	
G-23	T-Strip	2	

H-00 Accessory

Code	Description	Qty.	Preview
H-01	Power Cord	1	
H-02	Screw Hole Sticker	16	
H-03	Safety Hammer	1	
H-04	Bottom Panel Pad	10	
H-05	Wire Hole Cover	1	

ASSEMBLY INSTRUCTIONS

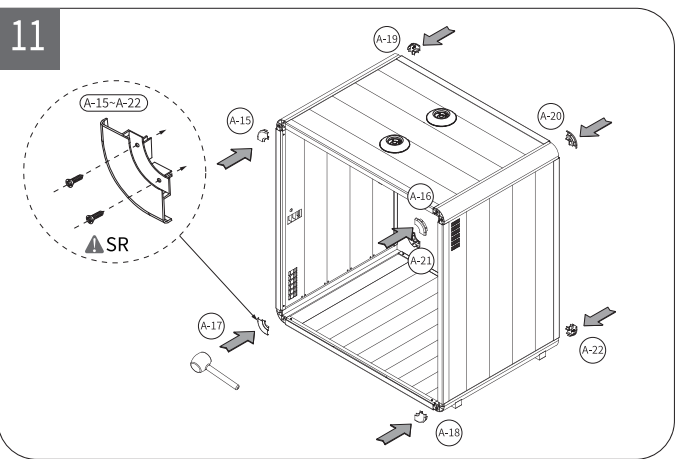
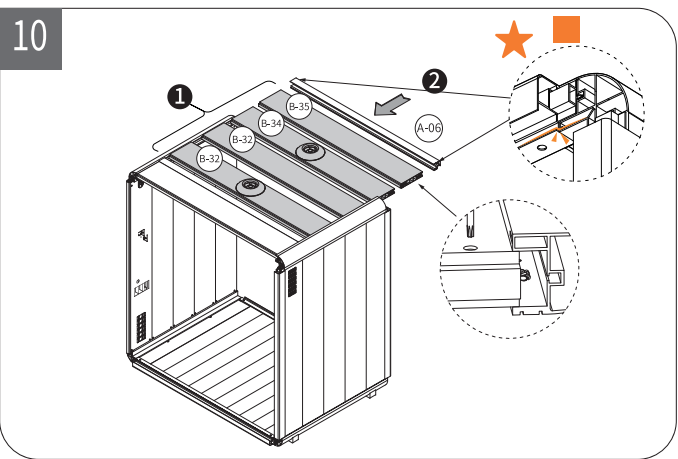
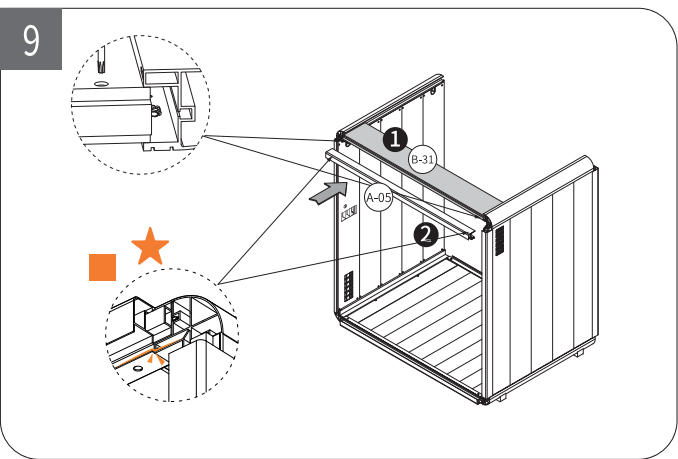
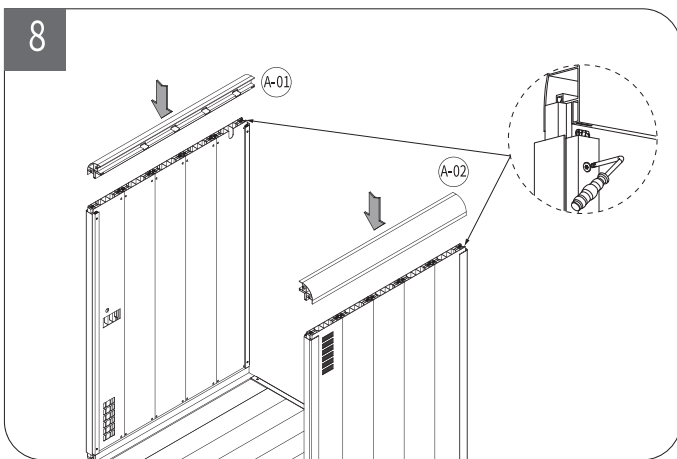
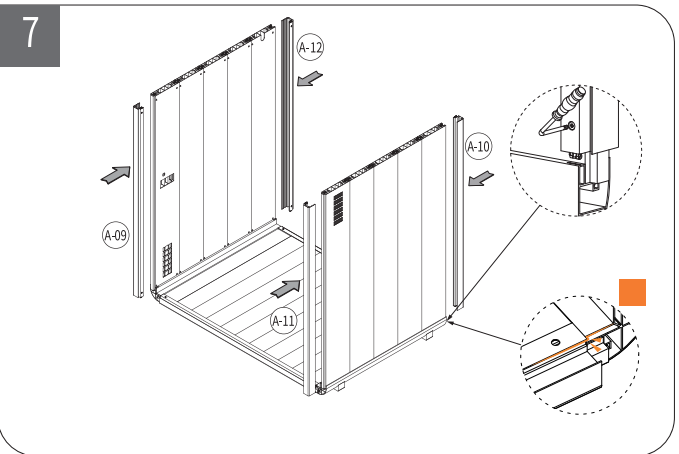
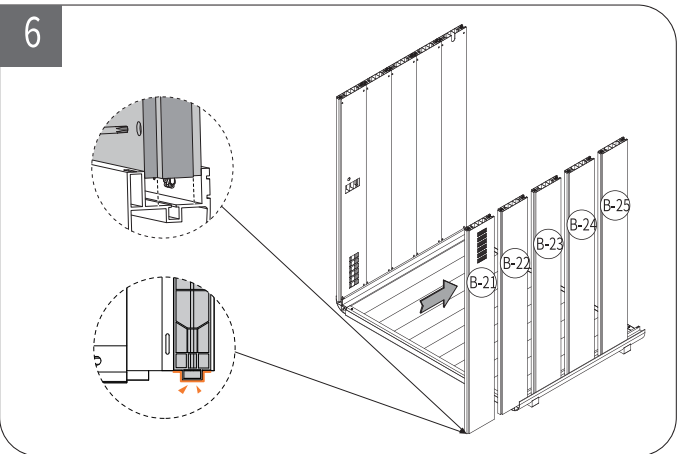
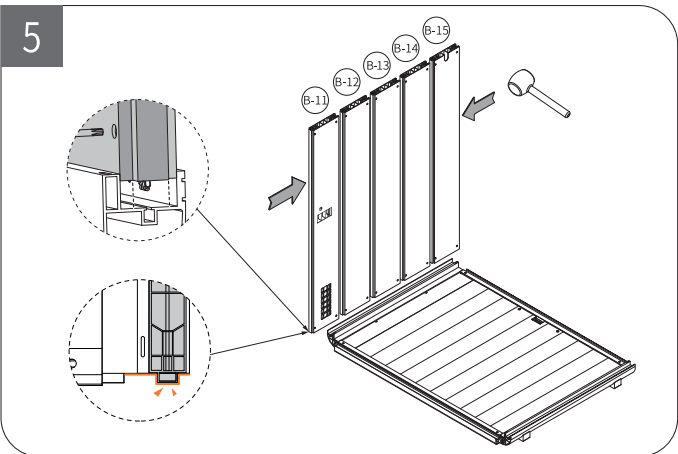
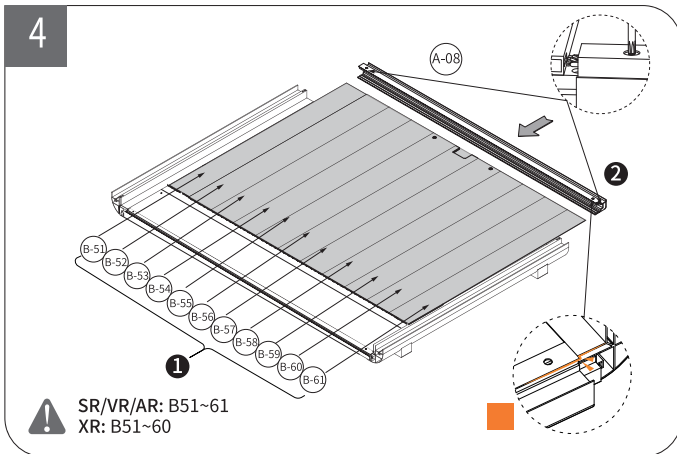
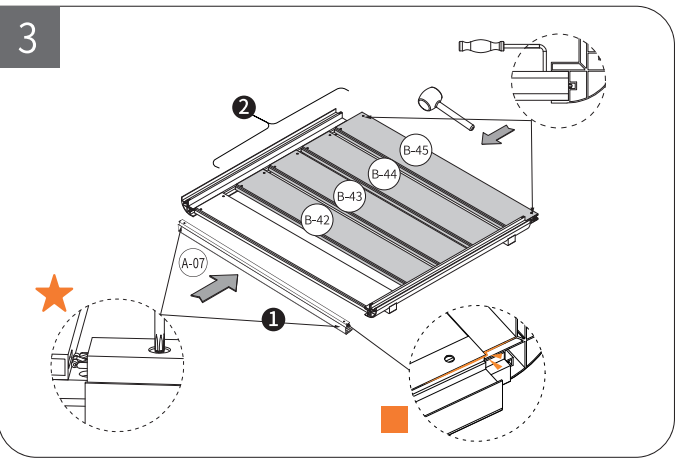
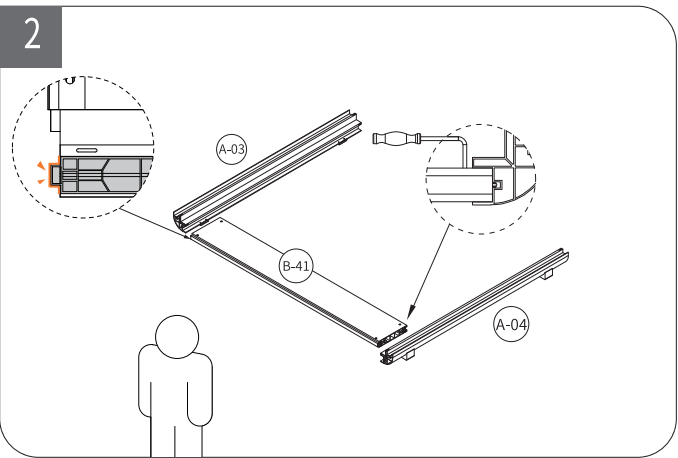
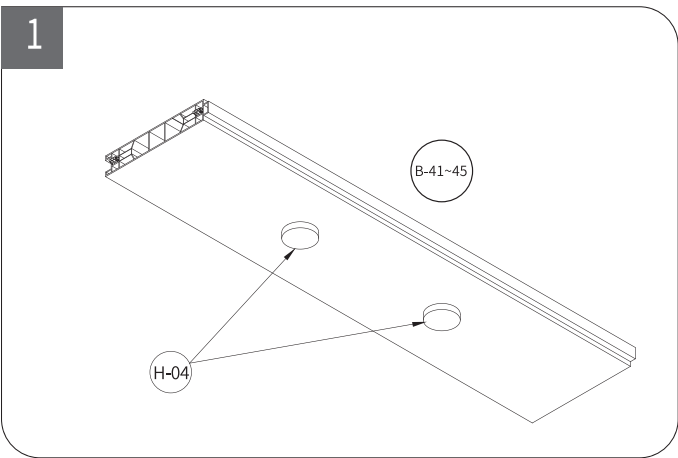
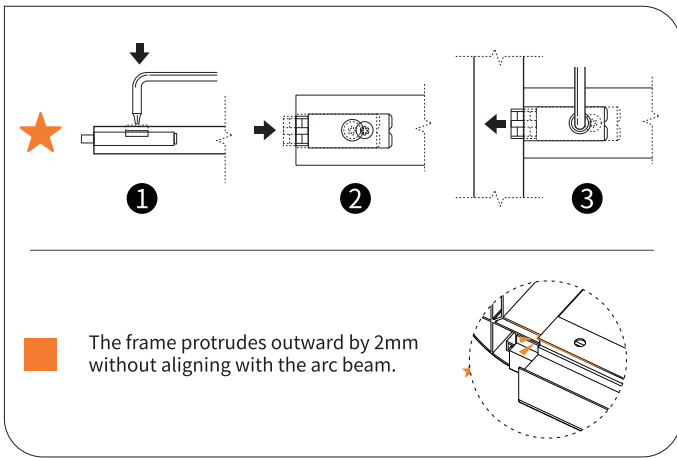

PRODUCT SPECS

External size:  
W2200\*D1536\*H2346mm  
(W86.61"\*D60.47"\*H92.36")

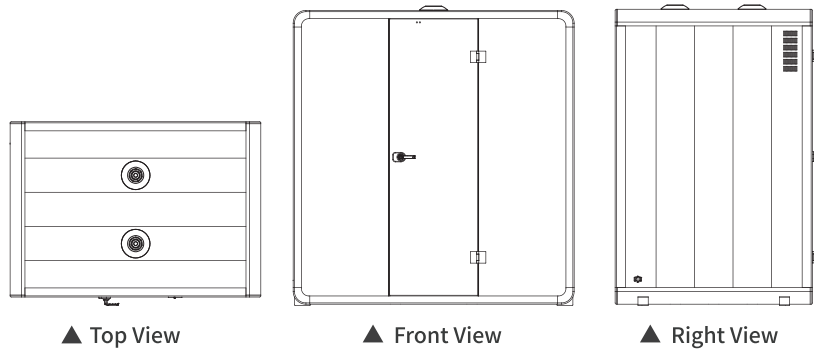

CIRCUIT DIAGRAM

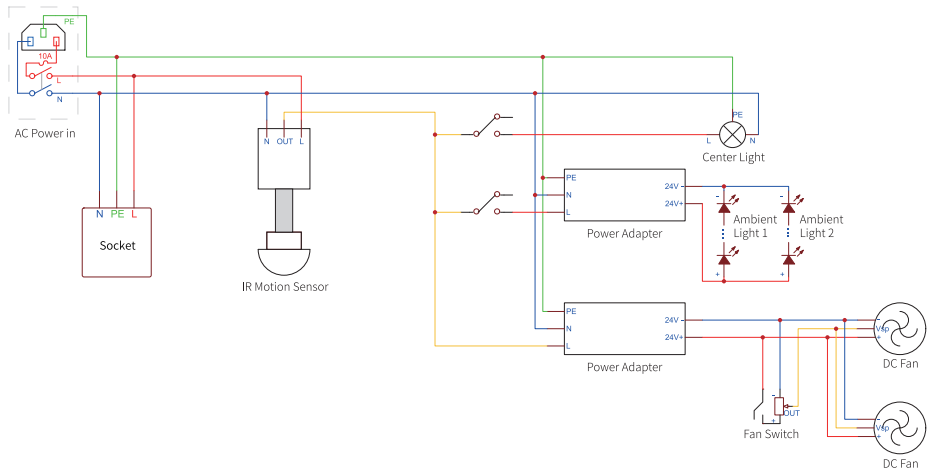

READ BEFORE START

Thanks for choosing our product, please mind these tips below during the installation:

1. Two people should be prepared for the installation.
2. Please use cushioning material for stacking parts after unboxing in case of damaging floor or product.
3. Please don't scratch any piece with a sharp tool.
4. Please check all listed tools are prepared.
5. Please check the space for installation is sufficient.
6. Please follow the step by number to build.

PRODUCT INTRODUCTION

